

# 2,033 Sq. Ft. Warehouse FOR LEASE



**5432-B W. Crenshaw Street • Tampa, FL 33634**



<b>SPACE SIZE:</b>	2,033 Sq. Ft.
<b>OFFICE:</b>	554 Sq. Ft.
<b>WAREHOUSE:</b>	1,479 Sq. Ft.
<b>LOADING:</b>	1 Grade Level (10'x10')
<b>CLEAR HEIGHT:</b>	24 Feet
<b>BREAK AREA:</b>	Refrigerator, microwave, water cooler & sink included
<b>SPRINKLER:</b>	Standard wet system
<b>SIGNAGE:</b>	Monument sign on Crenshaw
<b>LEASE RATE:</b>	\$12.95 NNN*

\*The lease rate is based on a 5 year lease term.

**Industrial Property Group, Inc.**

Licensed Real Estate Broker

[www.ipgcommercialrealty.com](http://www.ipgcommercialrealty.com)

2202 N. Westshore Blvd. • Suite 200 • Tampa, FL 33607

FOR MORE INFORMATION CONTACT:

**CRAIG M. CAPO**

Cell: 813.335.3361

[craig@ipgcommercialrealty.com](mailto:craig@ipgcommercialrealty.com)

**KELLI HATTON**

Cell: 813.454.1619

[kelli@ipgcommercialrealty.com](mailto:kelli@ipgcommercialrealty.com)



No warranty or representation, expressed or implied, is made as to the accuracy of the information contained herein, and same is submitted subject to errors, omissions, change of price, rental or other conditions, withdrawal without notice, and to any special listing conditions imposed by our principals.

**5432-B W. Crenshaw Street  
Tampa, FL 33634**

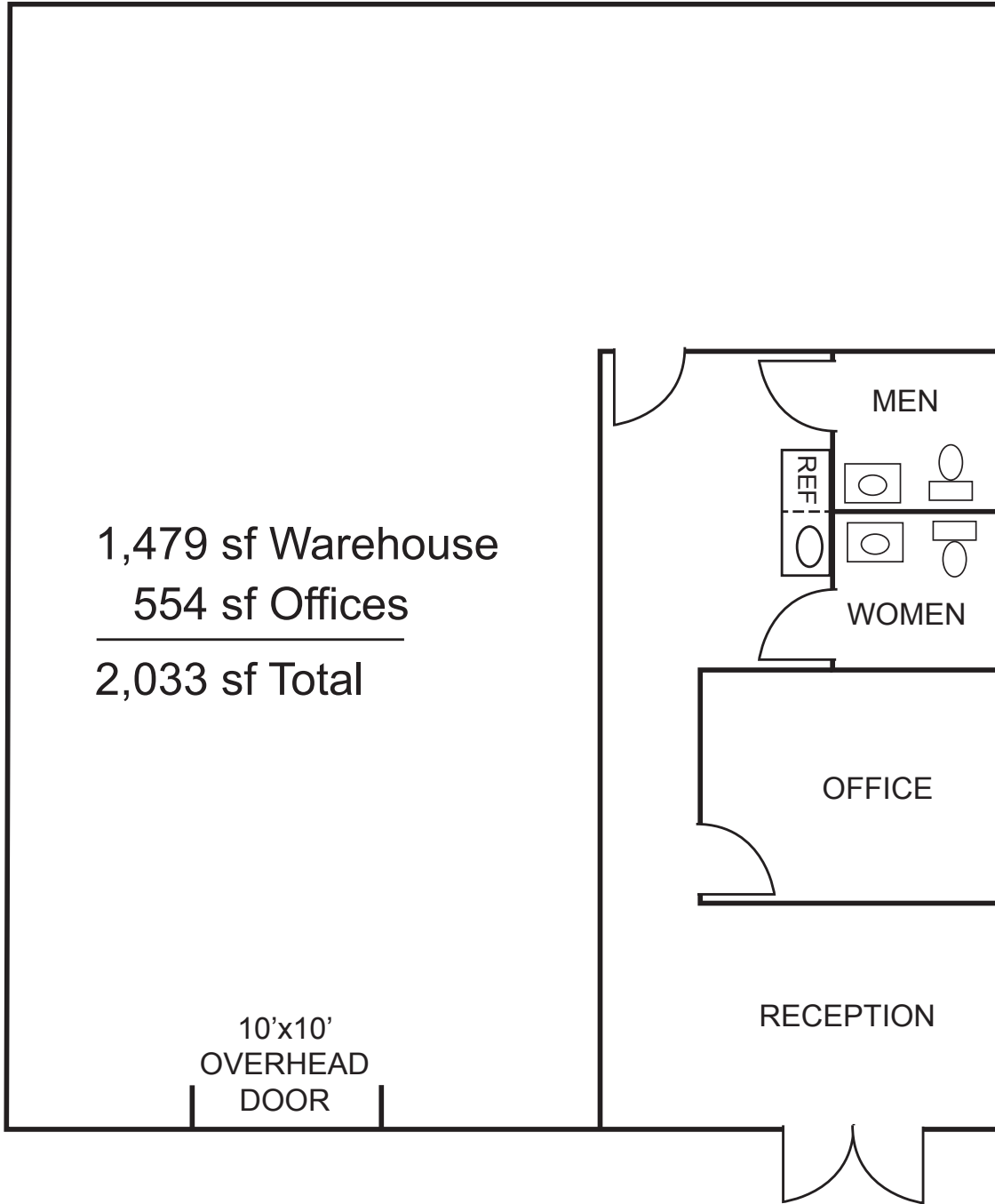

**Industrial Property Group, Inc.**

Licensed Real Estate Broker

[www.ipgcommercialrealty.com](http://www.ipgcommercialrealty.com)

2202 N. Westshore Blvd. • Suite 200 • Tampa, FL 33607

FOR MORE INFORMATION CONTACT:

**CRAIG M. CAPO**

Cell: 813.335.3361

[craig@ipgcommercialrealty.com](mailto:craig@ipgcommercialrealty.com)

**KELLI HATTON**

Cell: 813.454.1619

[kelli@ipgcommercialrealty.com](mailto:kelli@ipgcommercialrealty.com)



No warranty or representation, expressed or implied, is made as to the accuracy of the information contained herein, and same is submitted subject to errors, omissions, change of price, rental or other conditions, withdrawal without notice, and to any special listing conditions imposed by our principals.